

SKW/SKS High-voltage Damped Resistor

Catalogue

- Features
- Construction
- Dimensions
- Reference Standards
- Ordering Information
- Derating Curve
- Performance

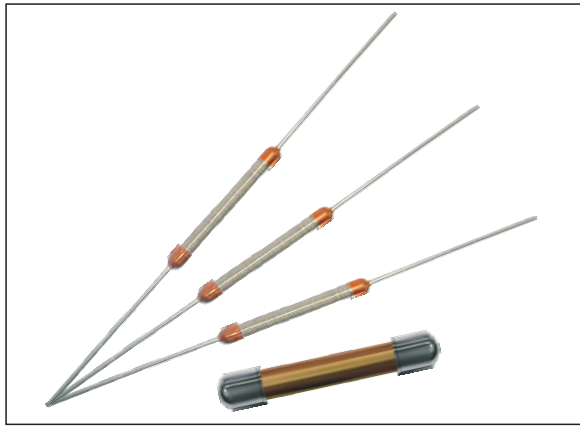

Features

High resistance, high overload capacity,
Widely used in automotive ignition device

Constructions

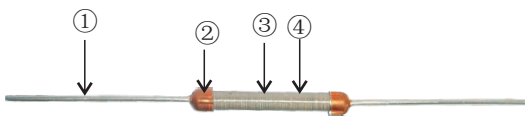

①	Lead wire
②	Cap
③	Glass fiber rod
④	Wire wound

Dimensions

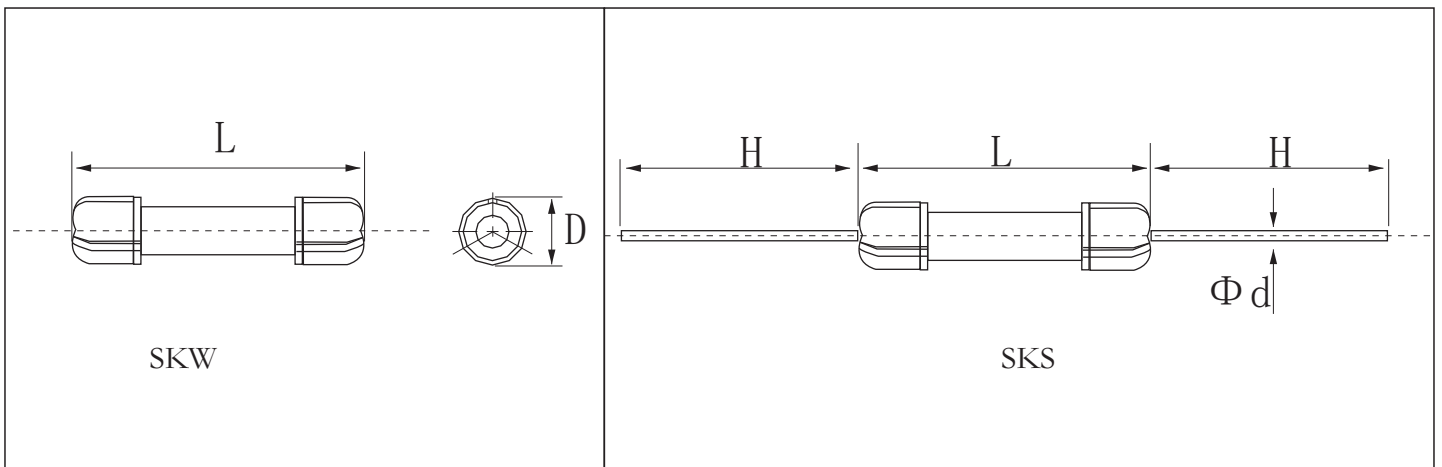

Type	Power (W)	Dimensions (mm)				Resistance range (Ω)
		L ± 0.5	H ± 3.0	D ± 0.1	d ± 0.05	
SKW/SKS	1W	16.0	28.0	3.5 or 3.75	0.8	1KΩ~10KΩ
SKW/SKS	2W	20.0	28.0	3.75	0.8	
SKW/SKS	3W	23.5	28.0	3.75	0.8	
SKW/SKS	4W	28.0	28.0	4.00	0.8	
SKW/SKS	5W	28.0	28.0	4.2 or 4.5	0.8	

Reference Standards

JISC 5201-1

Ordering Information

Example:

SKW	05	K	10R
(1)	(3)	(4)	(5)
Series Name	Power Rating	Resistance Tolerance	Resistance

(1) Series Name: SKW, SKS Series

(3) Power Rating: 01=1W, 02=2W, 03=3W, 04=4W, 05=5W

(4) Resistance Tolerance: K: $\pm 10\%$ 、M: $\pm 20\%$

(5) Resistance: 1000R00=1000 Ω , 5000R00=5000 Ω

Derating Curve

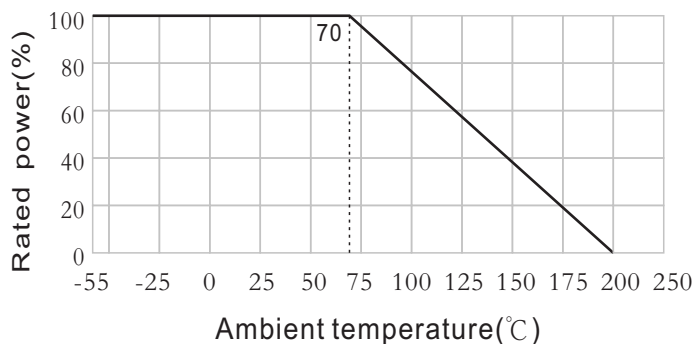

Performance

Item	Performance requirements(JIS C 5201-1)
Temperature coefficient	$\pm 250\text{PPM}/^\circ\text{C}$
Short time overload	$\Delta R \leq \pm (1\%R_0 + 0.05\Omega)$
Tolerance	K $\pm 10\%$, M $\pm 20\%$
Climate type	55/155/21
Temperature range	-55 $^\circ\text{C}$ — 200 $^\circ\text{C}$
Lower power temperature range	When the environment temperature from 70 $^\circ\text{C}$ to 200 $^\circ\text{C}$; Resistor to allow Load by 100% of the rated power down to zero
Load in normal temperature	$\Delta R \leq \pm (5\%R_0 + 0.01\Omega)$
Terminal strength	$\Delta R \leq \pm (1\%R_0 + 0.05\Omega)$